

4.20mm(0.165") ATX Dual Row Straight

SPECIFICATIONS

Current Rating: 3 Amp
 Insulator Resistance: 1000 Megohms min.
 Dielectric Withstanding: AC 500V
 Contact Material: Phosphor Bronze
 Insulator Material: NY-66 (UL94V-0) ROHS
 Plated(*Standard): Tin Plated

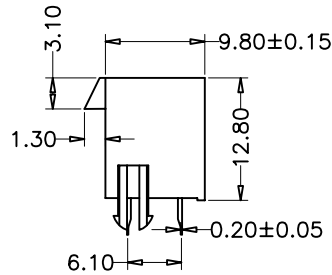
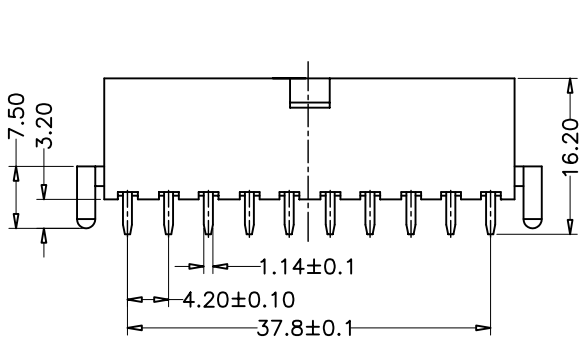
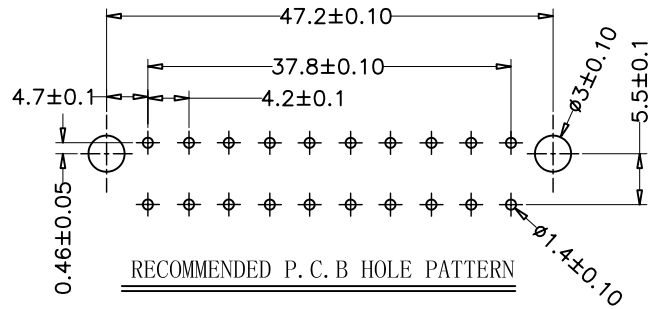
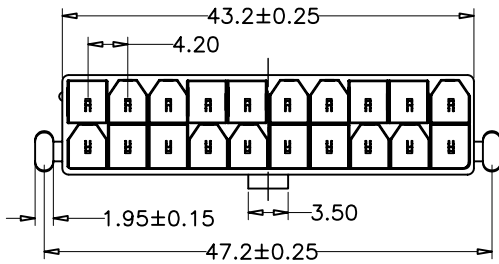
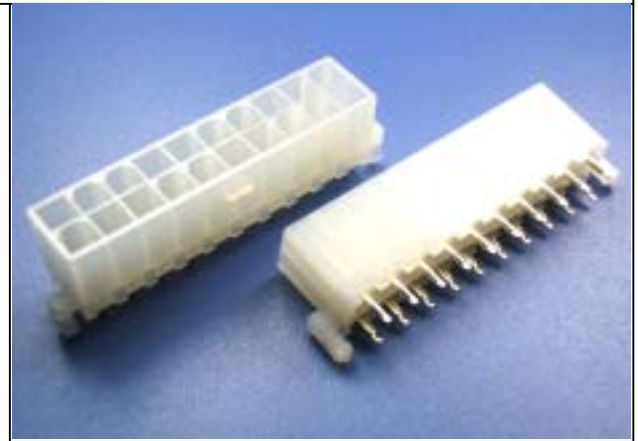

How to order the Part No. (Please replace "X" with appropriate coding listed in the tables below.)

ATX	X	X	XX	--	X	XX	--	XX
Connector Pitch	Pin NO	Pin NO			Housing Colour	Contact Plating		Glide NO
F 4.20mm H 3.00mm	W Pole N No Pole	06 to 64			01 Black 02 Blue 03 Green 04 Yellow	01 Tin 02 Gold Flash 03 Gold/Tin		01-99