

2.5mm(0.1") Wafer Single Row R/A 02 to 16 Contacts

SPECIFICATIONS

Current Rating:	3 Amp
Voltage Rating:	AC 250V
Insulator Resistance:	1000 Megohms min.
Withstand Voltage:	AC 1000V min
Operating Temp. :	-40° C~+105° C
Insulator Material:	PA-66(UL94V-0) ROHS
Contact Material:	Brass
Plated(*Standard):	Tin Plated

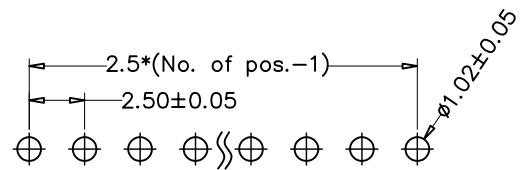
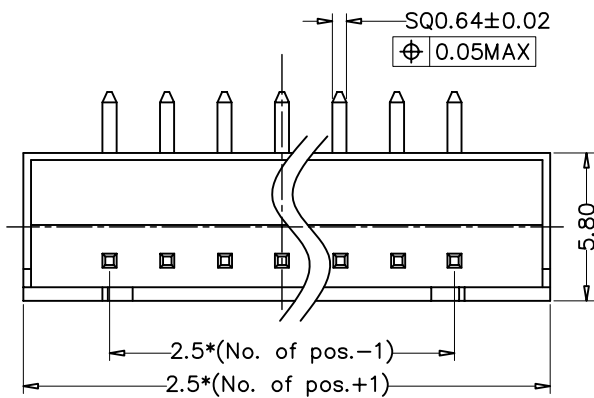
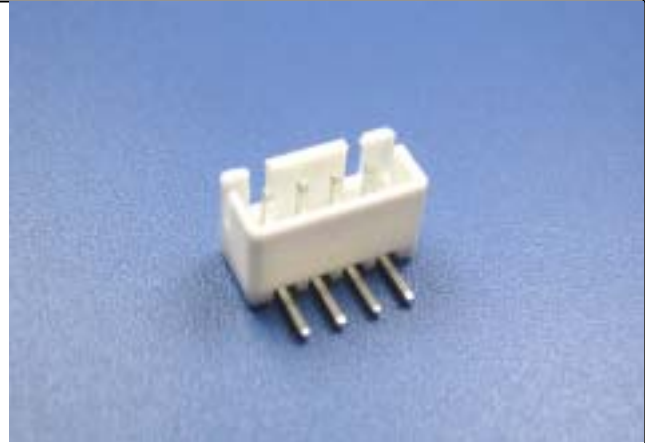

Recommended P.C.B Layout

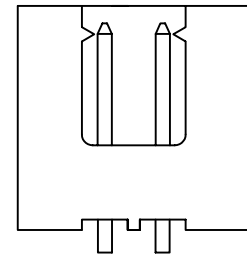
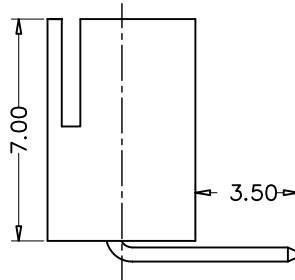
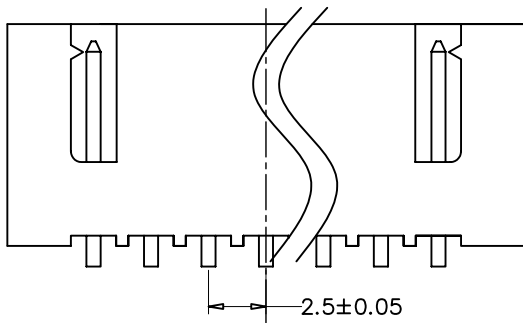

2PIN

How to order the Part No. (Please replace "X" with appropriate coding listed in the tables below.)

W	X	X	X	XX	--	X	XX	--	XX
Pitch	Versions	Row Option	Pin NO	Connector Type	Contact Plating	Glide NO			
B 0.80mm C 1.00mm D 1.25mm F 2.00mm G 2.50mm H 2.54mm I 3.96mm K 5.08mm	A 180° B 90° C SMT	1 Single Row 2 Dual Row	02 to 20	A: A Type B: B Type	01 Tin 02 Gold Flash 03 Gold/Tin	01-99			